

JSL 3D

INNOVATIONS

Consumer Resin



Scan to visit our website.

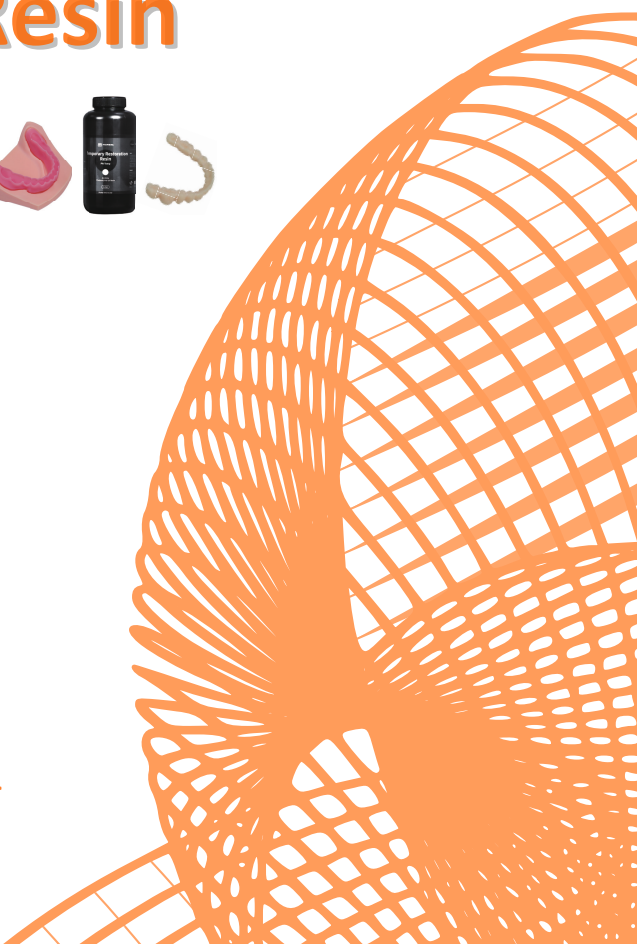

Make Life Better | Make Change Happen | Make a Different

CONTENTS

Dental 3D Solution	1
Model Maker 3D Solution	6

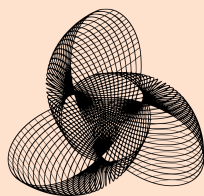

JSL 3D

INNOVATIONS

Tel: +44(0)1224790302
Fax: +44(0)1224790008

Email: sales@jodanlservices.com
Website: www.jsl3d.co.uk

Removable Die Model Resin



Biocompatible resin for dental models. Fast Forming Speed, High Precision and Surface Abrasion Resistance.

Hardness	ASTM D2240	/	> D90
Flexural Modulus	ASTM D790	MPa	> 2000
Flexural Strength	ASTM D790	MPa	> 60
Elongation at Break	ASTM D638	/	> 10

Cytotoxicity	ISO 10993-5	Allergenicity	ISO 10993-10	Irritant	ISO 10993-10
--------------	-------------	---------------	--------------	----------	--------------



Feature

- High Modeling Speed
- High Edge Stability
- High Forming Precision
- Surface Abrasion Resistance
- High Detail Reduction
- MMA/THF-MA Free Formula



Colour: Wheat Complexion/ Gray, Customizable

Ortho Model Resin



Biocompatible resin for dental models. Fast Forming Speed, High Precision, Super High Surface Hardness and Super High Surface Hardness

Hardness	ASTM D2240	/	> D90
Flexural Modulus	ASTM D790	MPa	> 1500
Flexural Strength	ASTM D790	MPa	> 50
Elongation at Break	ASTM D638	/	> 5
Heat Deflection Temperature	ASTM D648 @ 66PSI	°C	>120

Cytotoxicity	ISO 10993-5	Allergenicity	ISO 10993-10	Irritant	ISO 10993-10
--------------	-------------	---------------	--------------	----------	--------------



Feature

- High Printing Speed
- High Edge Stability
- High Forming Precision
- High Temperature Resistance
- High Detail Shape Stability after curing



Colour: Yellow/ Beige/ Gray

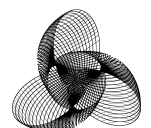

Ortho Model Resin 2.0



Cost Effective, Fast Forming Speed, High Precision and Super High Surface Hardness.

Hardness	ASTM D2240	/	> D85
Flexural Modulus	ASTM D790	MPa	> 1200
Flexural Strength	ASTM D790	MPa	> 85
Tensile Modulus	ASTM D638	MPa	> 700
Tensile Strength	ASTM D638	MPa	>30
Heat Deflection Temperature	ASTM D648 @ 66PSI	°C	>100
Cytotoxicity	ISO 10993-5	Allergenicity	ISO 10993-10
		Irritant	ISO 10993-10



Feature

- Cost Effective
- High Modeling Speed
- High Edge Stability
- High Forming Precision
- High Detail Reduction
- Low Viscosity

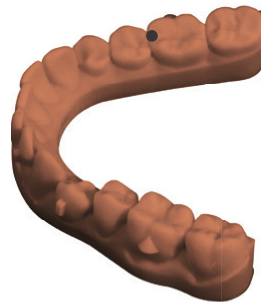

Colour: Yellowish Brown/ Gray, Customizable

Temporary Restoration Resin



Biocompatible resin for Temporaies. Ultra High Flexural / Tensile Strength, Low Water Absorption.

Hardness	ASTM D2240	/	> D90
Flexural Modulus	ASTM D790	MPa	> 2200
Flexural Strength	ASTM D790	MPa	> 120
Tensile Modulus	ASTM D638	MPa	> 700
Tensile Strength	ASTM D638	MPa	> 80
Elongation at Break	ASTM D638	%	> 8
Water Absorption	ASTM D570	%	<1.5
Cytotoxicity	ISO 10993-5	Allergenicity	ISO 10993-10
		Irritant	ISO 10993-10



Feature

- Ultra High Flexural Tensile Strength
- Easy to Polish
- color Selectivity
- Low Water Absorption
- MMA/THF-MA Free Formula
- Excellent Dimensional Stability

A1/A2/A3/B1/BL1



Colour: Customizable

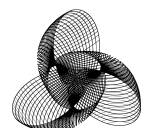

Surgical Guide Resin



Biocompatible resin for surgical guides. It's used to make guide plates for implant surgery, orthodontic guide plates, functional retainers.

Hardness	ASTM D2240	/	> D80
Tension Strength	ASTM D638	MPa	> 40
Flexural Strength	ASTM D790	MPa	> 50
Elongation at break	ASTM D638	/	> 15

Cytotoxicity	ISO 10993-5	Allergenicity	ISO 10993-10	Irritant	ISO 10993-10
--------------	-------------	---------------	--------------	----------	--------------



Feature

- Easy to drill
- High Sharp Precision
- High Flexural Strength
- Transparent to See Drill Position
- Low Yellowing
- MMA/THF-MA Free Formula



Colour: Transparent

Dental Casting Resin



Biocompatible resin for dental casting. It's suitable for the production of 3D printed and cast metal crown, metal bridge and metal bracket.

Hardness	ASTM D2240	/	> D80
Flexural Modulus	ASTM D790	MPa	> 1500
Flexural Strength	ASTM D790	MPa	> 70
Bakeout Temperature	/	/	> 1.5h @ 850 °C



Feature

- High Molding Speed
- Residue Free
- High Forming Precision
- Fast Burning
- High Detail Reduction
- Low Shrinkage

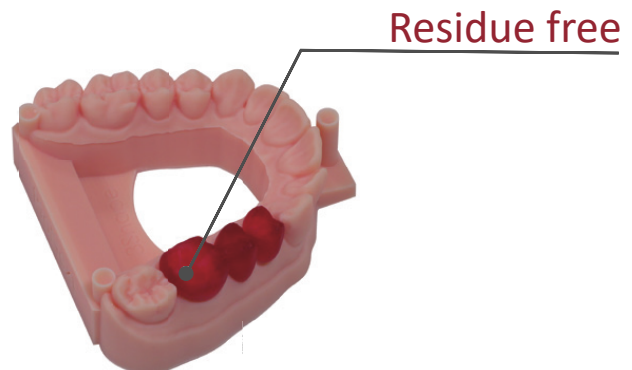

Colour: Cherry Red/ Green

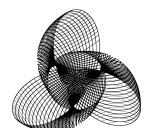

Water-washable Dental Resin



Biocompatible resin for dental models. Fast Forming Speed, High Forming Precision and Water-washable.

Hardness	ASTM D2240	/	> D85
Flexural Modulus	ASTM D790	MPa	> 1200
Flexural Strength	ASTM D790	MPa	> 60
Tensile Modulus	ASTM D638	MPa	> 700
Tensile Strength	ASTM D638	Mpa	> 30
Elongation at Break	ASTM D638	J/m	>10
Heat Deflection Temperature	ASTM D648 @ 66PSI	°C	>80



Feature

- Water-washable
- Perfect Details
- No Use of Solvent Necessary
- MMA/THF-MA Free Formula
- Excellent Dimensional Stability



Colour: Orange/ Gray/ Clear Blue

Try-in Denture Resin



Biocompatible resin for try-in denture. It's suitable for dental related applications such as temporary removable denture base/ try-in denture base model.

Hardness	ASTM D2240	/	> D80
Flexural Modulus	ASTM D790	MPa	> 2200
Flexural Strength	ASTM D790	MPa	> 100
Tensile Modulus	ASTM D638	MPa	> 700
Tensile Strength	ASTM D638	MPa	>80
Elongation at Break	ASTM D638	%	>8
Water Absorption	ASTM D570	%	<1.5



Feature

- Ultra High Flexural Strength
- Perfect Details
- Durable
- Low Water Absorption
- Bio-Compatible
- MMA/THF-MA Free Formula



Colour: Red

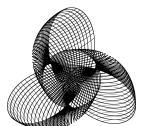

Gingiva Resin



Superior Molding Stability, Elasticity and Tear Resistance. To combine with dental model materials to perform functional 3D reproduction of functional gingival model fragments.

Hardness	ASTM D2240	/	> A30
Elongation at Break	ASTM D638	%	> 80
Tear Strength	ASTM D624	N/mm	> 5



Colour: Gingival Red

Feature

- Excellent Elasticity
- Tear Resistance
- Excellent Dimensional Stability
- MMA/THF-MA Free Formula
- Durable

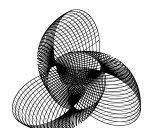

PC-Rigid

Standard Rigid Resin

Application Field: anime figure, decorative item, etc.

High adaptability: It can be adapted to most of mainstream models in the market. Widely used in making figures, teaching aids, toys, handicrafts, industrial parts, etc.

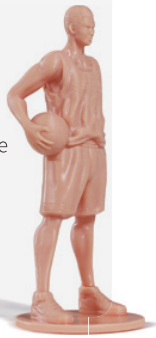

PC-Clear

High Transparency Resin

Application field: anime figure, decorative item, etc.

High accuracy: the detail texture is well expressed when printing anime figures. Good liquidity, high transparency and high hardness 3D printing resin. This resin presents low contraction, high penetration, high toughness and other mechanical properties.



PN-WW

Water Washing Resin

Application field: anime figure, decorative item, etc.

This resin presents low odor, low contraction and washability. Instead of using organic solvent to wash, it can be directly washed by water, in this way, avoid the using of volatile organic compounds and the security concerns.

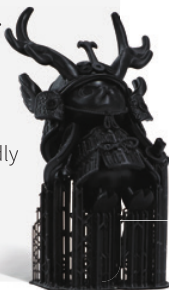
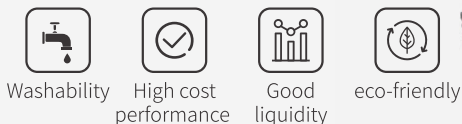

PC-ABS

ABS Resin

Application field: clock and watches, glasses, industrial parts and industrial figures.

This resin presents high printing speed, low contraction, high accuracy, high hardness, and excellent toughness. This resin is suitable for structural sample, industrial figure, industrial parts, etc.



PC-Flexible

Flexible Resin

Application field: soft object fabrication, for example watchband, pad, etc.

Flexible resin is a 3D printer light cure resin with good flexibility and elongation.



Softness characteristics



Good wear resistance



Smooth surface



Low curing time



PC-Matte

High Fidelity Model Resin

Application fields: figures, handicrafts, footwear, teaching and research, toy design, etc.

Model details are realistically presented with matte surface, finished models are easy to color and observed details; it is compatible with all 405 nm UV 3D printers.



Matte finish surface



High accuracy



Easy to colour



Toughness and toughness coexist



PC-Bio

PLA-based Resin

Application field: Anime figures and models with high resolution requirements.

Plant starch purification, green, and friendly to the environment, Naturally degradable, harmless to the environment.



Environmental friendly



Low odor



Soft color



Wide compatibility



PC-HT

High-temp Resin

Application fields: jewelry ring die-casting mother mold, small batch low-temperature molds, silicone mold, rubber mold, high-temperature resistant parts, industrial structural parts, and so on.

High temp resin is a temperature-resistant UV curable resin for 3D printing. This resin has the characteristics of high dimensional stability and good high temperature resistance.



Good high temperature resistance



High dimensional stability



High accuracy



Good wear resistance

